

MISSION STATEMENT

We are committed to educating our Clients to the process of design so that they can make the best decisions for their projects. It is our philosophy that the task of an Architect is to take the desires and needs of our Clients and turn them into reality.

PROJECTS

Public Safety Project

- ALLEGANY ENGINE CO., Inc.- Allegany, NY
- GOWANDA VOLUNTEER FIRE DEPT. & TRI COUNTY TRAINING FACILITY- Gowanda, NY
- SUBSTATION for SOUTH LOCKPORT FIRE DEPT.- S.Lockport, NY
- MILLER HOSE COMPANY- Newfane, NY
- HAMLIN FIRE COMPANY- Hamlin, NY
- WRIGHTS CORNERS FIRE COMPANY- Wrights Corners, NY*
- GAINESVILLE FIRE COMPANY- Gainesville, NY

Hospitality Projects

- HAMPTON INN- Niagara Falls, NY
- COUNTRY INN & SUITES- Henrietta, NY
- HAMPTON INN- Bordentown, NJ

Commercial Projects

- GALLAGHER PRINTING-Clarence, NY
- JIMMIES ICE CREAM SHOP-Depew, NY
- Wilm Townhouses- West Palm Beach, FL
- GRACE WOLFE OFFICE- Stuart, FL
- REFLECTIONS HAIR DESIGN (INTERIORS)- Clarence, NY
- RED DIAMOND TOMATO THYME PLANT - Riverside, FL
- GREECE FAMILY RESTAURANT- Greece, NY
- MILLER BUILDING- Sarasota, FL
- SUN & SWIM POOLS STORE- Kansas City, MO
- MAINT. FACILITY DALSTON TRUCK LINES- Clay Center, NE
- AIRFREIGHT COMPLEXES-
 - Minneapolis St. Paul International Airport
 - Mitchell Field Milwaukee
 - Bakersfield & Fresno International Airports, CA
 - Greater Rochester International Airport, NY
- LAW OFFICE LANCE WELCH- Kansas City, MO

Education Projects

- VOCATIONAL / TECHNICAL FACILITY YATES CENTER H.S.
- Yates Center, KS
- FIELD HOUSE / GYMNASIUM @ FT. SCOTT COMMUNITY COLLEGE- Fort Scott, KS

Religious Projects

- BLUE SPRINGS BAPTIST CHURCH-Blue Springs, MO
- CHURCH OF CHRIST- Manhattan, KS
- CHURCH OF CHRIST- Raymore, MO

* = Project with other Firm

Our goal is to maximize our client's environment for work, play & living

-William L. Henderson, AIA

WLH
ARCHITECT

WL HENDERSON, ARCHITECT

5270 Salt Road, Clarence, NY 14031

Phone: (716)759-8783 / Fax: (716) 759-1694

www.wlhendersonarchitect.com

LICENSED: Florida, Kansas, Missouri, New Jersey, New York, North Carolina,
NCARB Certified

WLH
ARCHITECT

WL HENDERSON ARCHITECT

ARCHITECTURE, PLANNING &
CONSTRUCTION MANAGEMENT

COMMERCIAL / RESIDENTIAL



(Residence Wheatherby Lake, MO)

5270 Salt Road
Clarence, NY 14031
Phone: (716)759-8783 / Fax: (716) 759-1694
www.wlhendersonarchitect.com

CURRENT PROJECTS

MILLER HOSE COMPANY NEWFANE, NY IN CONSTRUCTION



GALLAGHER PRINTING, Inc. CLARENCE, NY IN CONSTRUCTION



An addition to a well established commercial printing company in Western New York. This addition will allow better service of "walk-in" clients.

ALLEGANY ENGINE COMPANY ALLEGANY, NY ON THE BOARDS

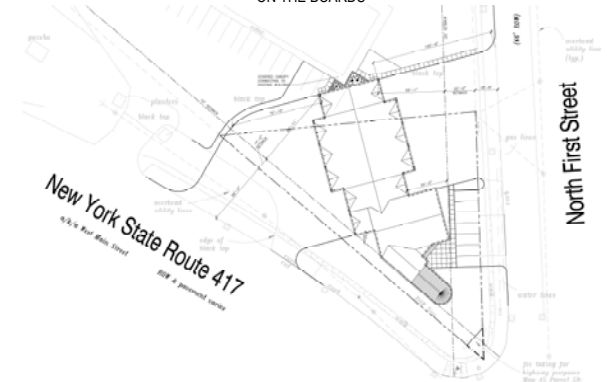

SUBSTATION for SOUTH LOCKPORT FIRE Co., Inc. SOUTH LOCKPORT, NY ON THE BOARDS

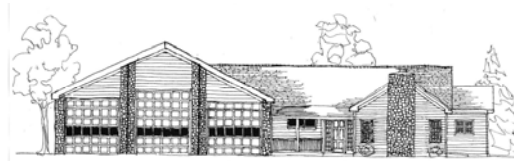

Situated in a residential neighborhood this substation seeks to maintain the fabric of the community while serving its fire and rescue needs.

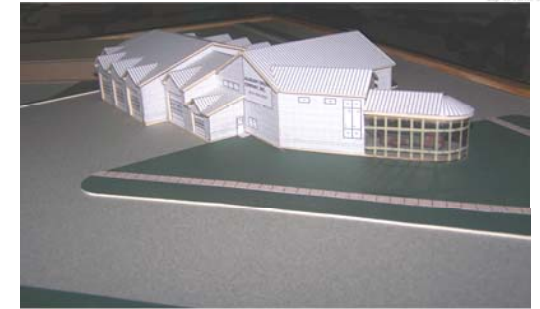

GRACE WOLFE OFFICE BUILDING STUART, FL ON THE BOARDS

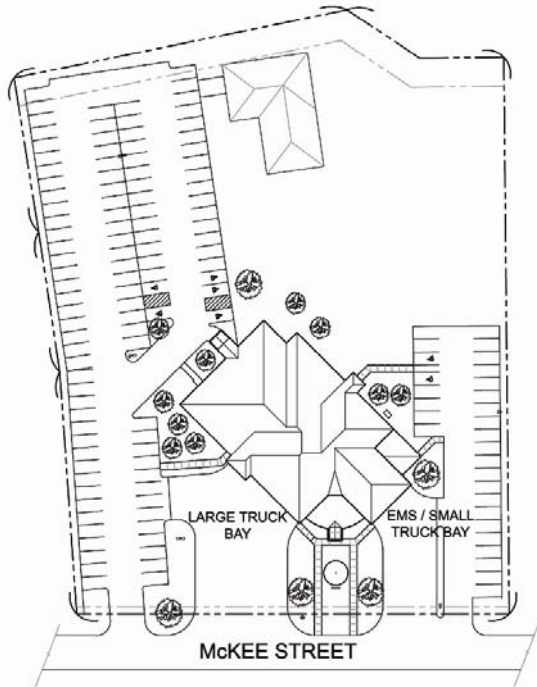

The distinctive split bay design of the apparatus bays allow for a unique axial approach to the building & created a signature entry for the fire station at its apex.